

ADITYA'S



# FORTUNE HEIGHTS

HITEC CITY



# THE NEW LANDMARK OF MODERN HI-RISE APARTMENTS.

Welcome to Aditya's Fortune Heights. The most premium and luxury homes coming up in vicinity of HiTec City. Fortune Heights is strategically located near HiTec City MMTS and in close proximity of Hafeezpet, Gachibowli, Kothaguda, Kondapur, JNTU, Kukatpally, Outer Ring Road with excellent connectivity to Financial District, International Schools, Five Star Hotels, Convention Centres, Shopping Malls, Entertainment centres and Airport. Fortune Heights offers you finest quality of construction and best of amenities such as Club House, Air Conditioned Gym, Health & Fitness centre, Children Play Area, Swimming pool, Power Backup, Multi Level Car Parking, Automatic lifts and Round the clock security.





FORTUNE  
HEIGHTS













TO HAFEEZPET

TO KPHB

GATE

GATE



# LAYOUT PLAN

# TYPICAL FLOOR PLAN

# BLOCK A

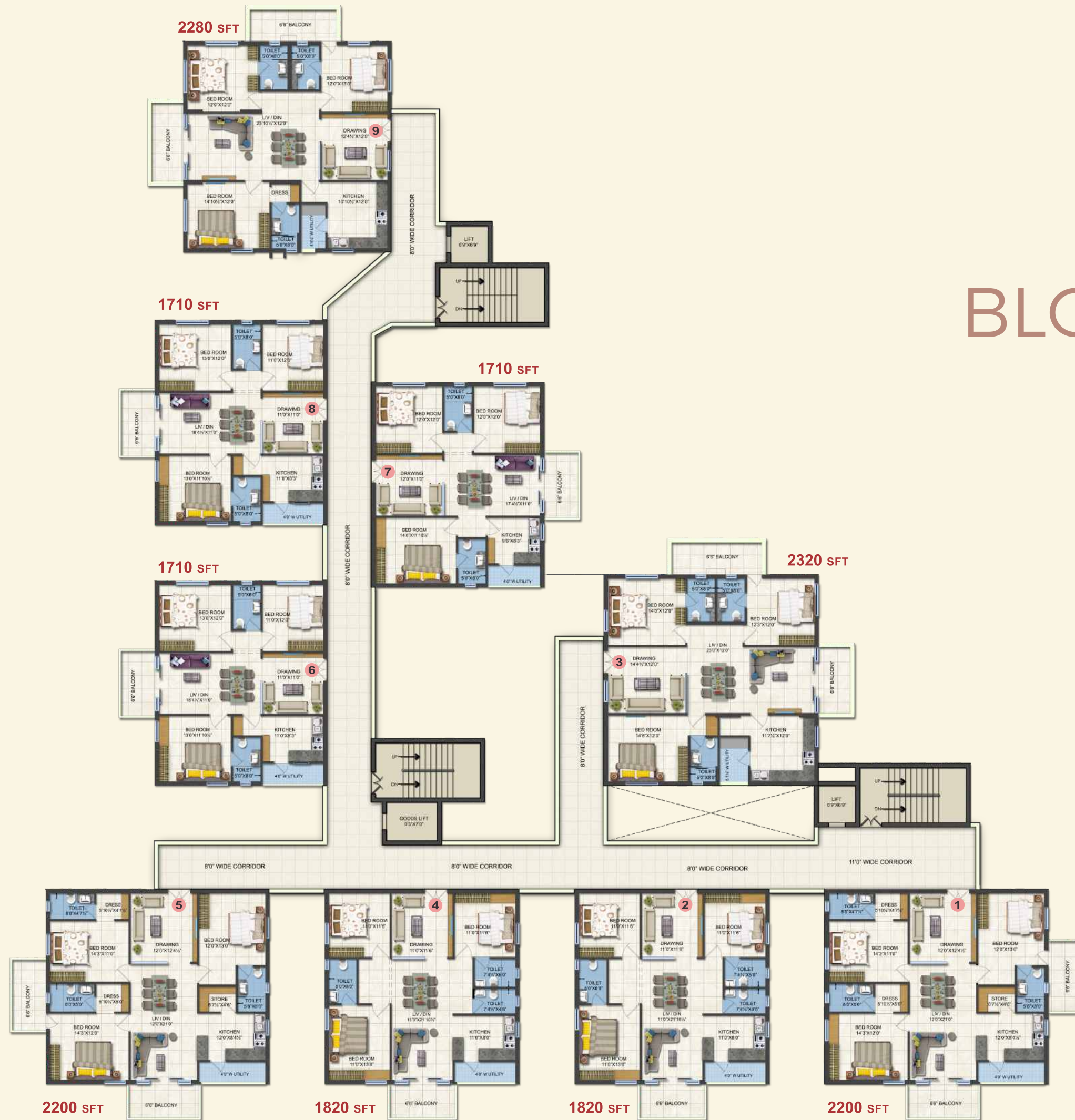

# TYPICAL FLOOR PLAN



## BLOCK B



# SPECIFICATIONS



## **STRUCTURE :**

R.C.C. framed structure. Footings columns, beams and slabs in R.C.C. in M25 grade concrete or higher grade concrete



## **SUPER STRUCTURE :**

First class brick work in cement mortar



## **PLASTERING :**

**Internal:** Double coat with sponge finish.

**Exterior:** Plastering in two coats with sponge finish



## **DOORS :**

**Main Door:** Teak wood frame and HDF designer skin molded paneled door shutter

**Internal Doors:** Teak wood door frame and HDF designer skin molded paneled door shutter with standard fittings & locks

**Windows:** UPVC glazed windows with glass panels fitted with standard hardware



## **PAINTING :**

**External:** Exterior texture paint with exterior emulsion paints of Asian / Equivalent

**Internal:** Smooth Wall putty finish with acrylic emulsion paints of Asian / Equivalent over a coat of primer



## **FLOORING:**

First quality Vitrified tiles in living room, bedrooms & kitchen



## **KITCHEN :**

Granite platform with stainless steel sink provision for fixing water purifier, ceramic tile dado up to 2' height above kitchen platform, Provision for exhaust & Chimney



**TELECOM :** Telephone points in all bed rooms & drawing room



## **BATHROOMS AND TOILET :**

a) Wash Basin : Pedestal wash basin

b) WC flush tank of Standard make

c) Hot and cold mixer with shower

d) Provision for geysers in toilets

e) All fittings are chrome plated

f) Tiles up to 7' height

g) Ceramic non slippery flooring



## **ELECTRICAL :**

Concealed wiring of Standard makes in Fire retardant wiring in conduits for lights, fan, plug and power plug points

a) Power outlets for air-conditioners in all bedrooms

b) Power outlets for geysers in all bathrooms

c) Power plug for cooking range chimney, refrigerator, micro wave ovens, mixer / grinder in kitchen

d) Adequate Plug points for refrigerator, TV & audio systems etc.

e) 3-phase supply for each unit and individual meter boards

f) All electrical fittings of Standard makes.



## **CABLE TV :**

Provision for Cable TV in all bedrooms and living room



## **INTERNET:**

One Internet provision in each flat



**GENERATOR :** 100% Power Back up except ACs, Geysers

# HIGHLIGHTS & AMENITIES

- Full Facility Club House
- Swimming Pool
- Gymnasium
- Power Backup Generator
- Round the clock security
- Multi Level Parking
- Automatic Lifts
- Children Play area
- Excellent Elevation from all sides
- Prime Location
- Excellent Connectivity
- Landscaped Garden
- Vaastu Compliant

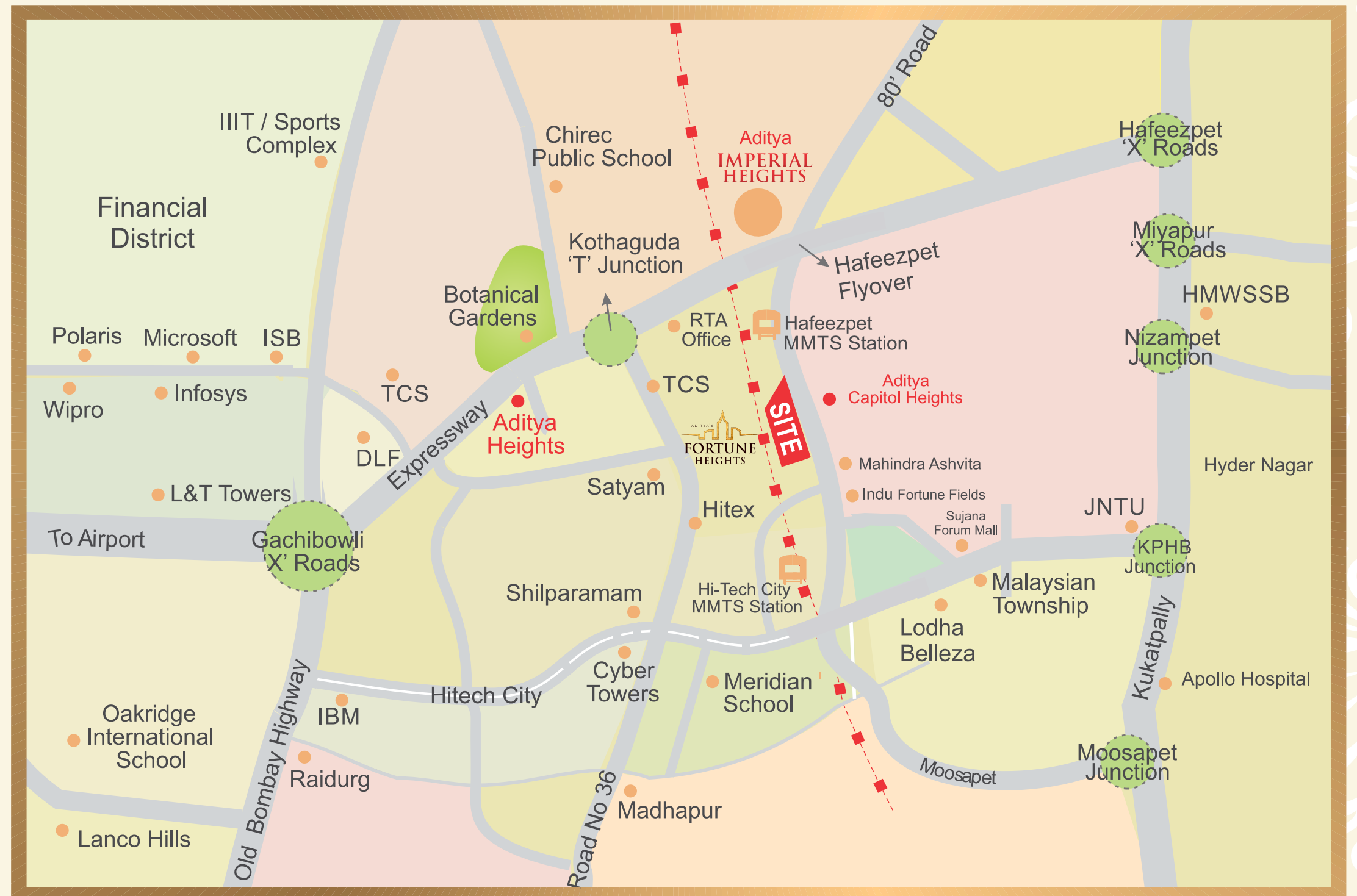

# LOCATION ADVANTAGES

05 - 10 MIN



D-MART



SUJANA FORUM MALL



HITECH CITY MMTS



GENPACT INDIA HQS



REMEDY HOSPITALS



VENKATESWARA TEMPLE



CYBER TOWERS



BOTANICAL GARDEN



SHILPARAMAM



JNTU



PVR MULTIPLEX

20 - 30 MIN



METRO MIYAPUR



SOUTH INDIA SHOPPING MALL



KFC



MC DONALDS



CITY CENTER MALL



KARACHI BAKERY



RAHEJA IT PARK



PEDDAMMA TEMPLE



PLATFORM 65 THE TRAIN RESTAURANT



LV PRASAD EYE HOSPITAL



GOLCONDA FORT



GSM MALL & MULTIPLEX



AIG HOSPITALS



DURGAM CHERUVU



RGI AIRPORT



## DRIVEN BY PASSION FOR QUALITY, INNOVATION AND LUXURY

Aditya Construction Company, is a reputed enterprise focused on developing luxurious gated communities with best of amenities. Established in the year 2002, the company has developed numerous luxury apartments & villas at prime locations in Hyderabad and Vizag. Over the years, Aditya has earned a reputation for quality and innovation. All its projects come with ample greenery, spacious, modern design and the best of amenities and of course, luxury. The company takes particular care in ensuring that its projects feature perfect vaasthu and a clear title so as to give buyers a hassle-free and happy ownership. Today, owning a Aditya property is associated with prestige as virtually every project the company has developed till date has become a landmark in its respective surroundings. Aditya is not about meeting the expectations, but exceeding them every time.



ADITYA'S



**FORTUNE  
HEIGHTS**

HITEC CITY



**Contact: 9912288892**

[www.adityacc.com](http://www.adityacc.com)

e-mail: [enquiry@adityacc.com](mailto:enquiry@adityacc.com)

[/AdityaConstructionCompan](https://www.facebook.com/AdityaConstructionCompany)

**Aditya Construction Company India Pvt. Ltd.**

Aditya Mansion, Plot No. A/29, Road No. 5, Jubilee Hills, Hyderabad